



HAMILTON

1026 Hamilton Dr., Holland, OH 43528
Phone: 419-867-4858/800-837-5561 • Fax 419-867-4857
www.hamiltonmfg.com

HOPPER SWITCH REPLACEMENT KIT

Kit Number (100-0151 & 100-0193)

Tools Required: 3/8" Nut Driver
1/4" Nut Driver
Medium Phillips Screwdriver

1. Turn off power to the machine.
2. Disconnect harness from hopper and remove from machine.
3. Using the medium Phillips screwdriver remove the #6-32 x 3/16" (90-0131) screws from the front cover and move to a safe place. Refer to Figure A.

Figure A

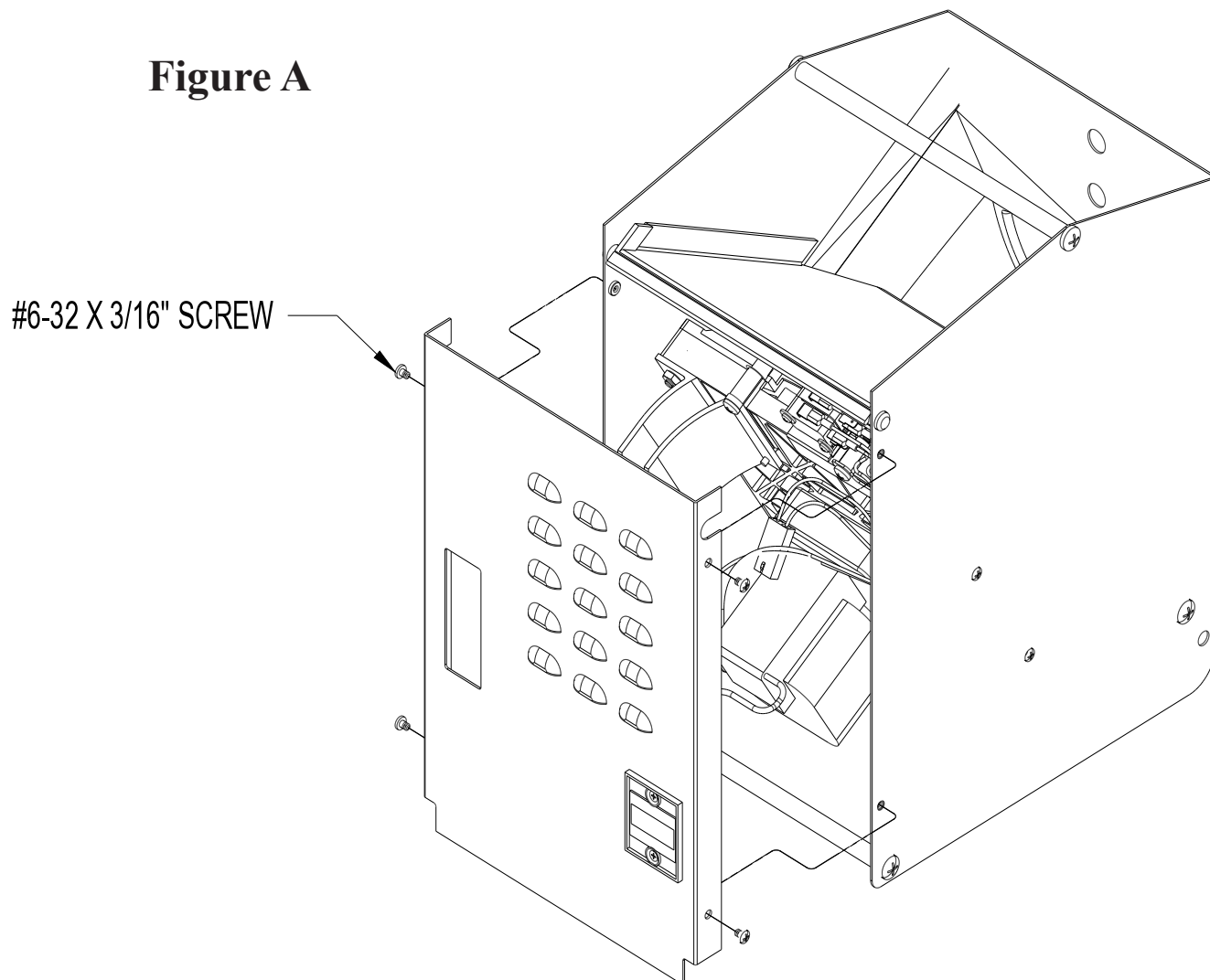

4. Remove Coin Baffle. Refer to Figure B

Note: If one has an ER-60 or ACW hopper locate the hopper pivot rod (handle) and remove the 2 #1/4-20 Philip head screws. Place rod and screws in safe place.

5. Disconnect quick connects from hopper switch.

6. Remove #4-40 x 1 1/2" (90-1026) screws and #4-40 (90-0306) locknuts holding switch in place. Save the hardware. Refer to Figure C

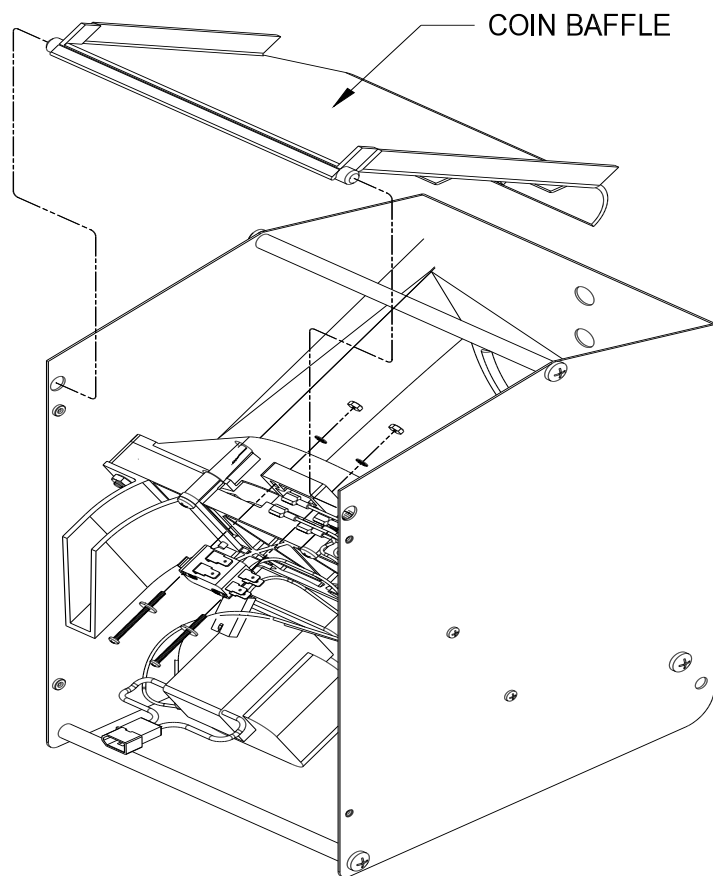
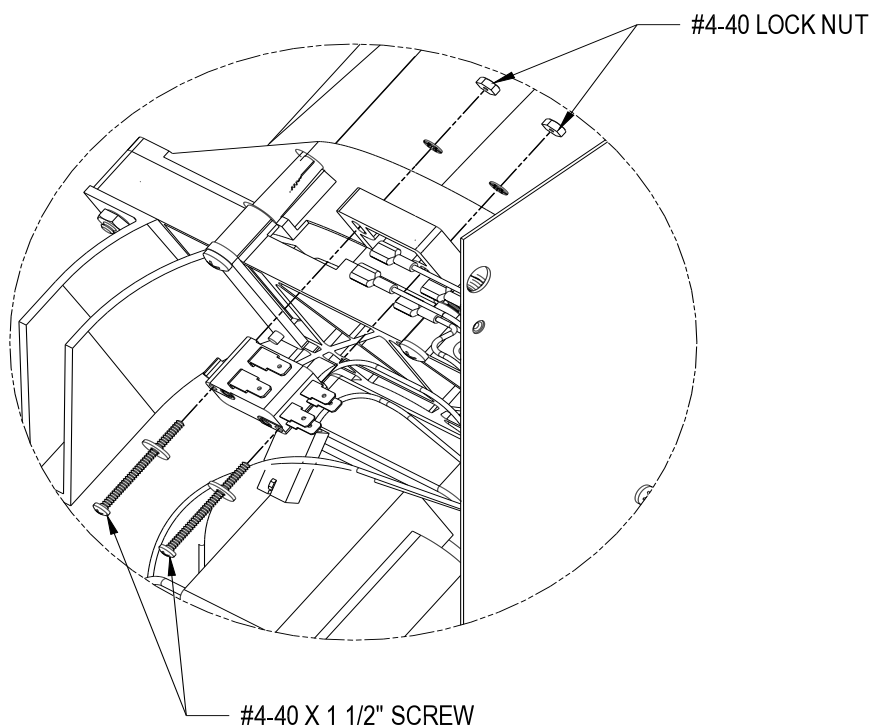

Figure B

Figure C



7. Remove #10-16 x 1 1/2" HI/LO screw and #10-32 (90-0160) nut indicated. Refer to Figure D
8. Attach assembly (11-8625 or 11-8626) using #10-16 x 1 1/2" HI/LO screw and #10-32 (90-0160) nut that was just removed. Refer to Figure E.

Figure D

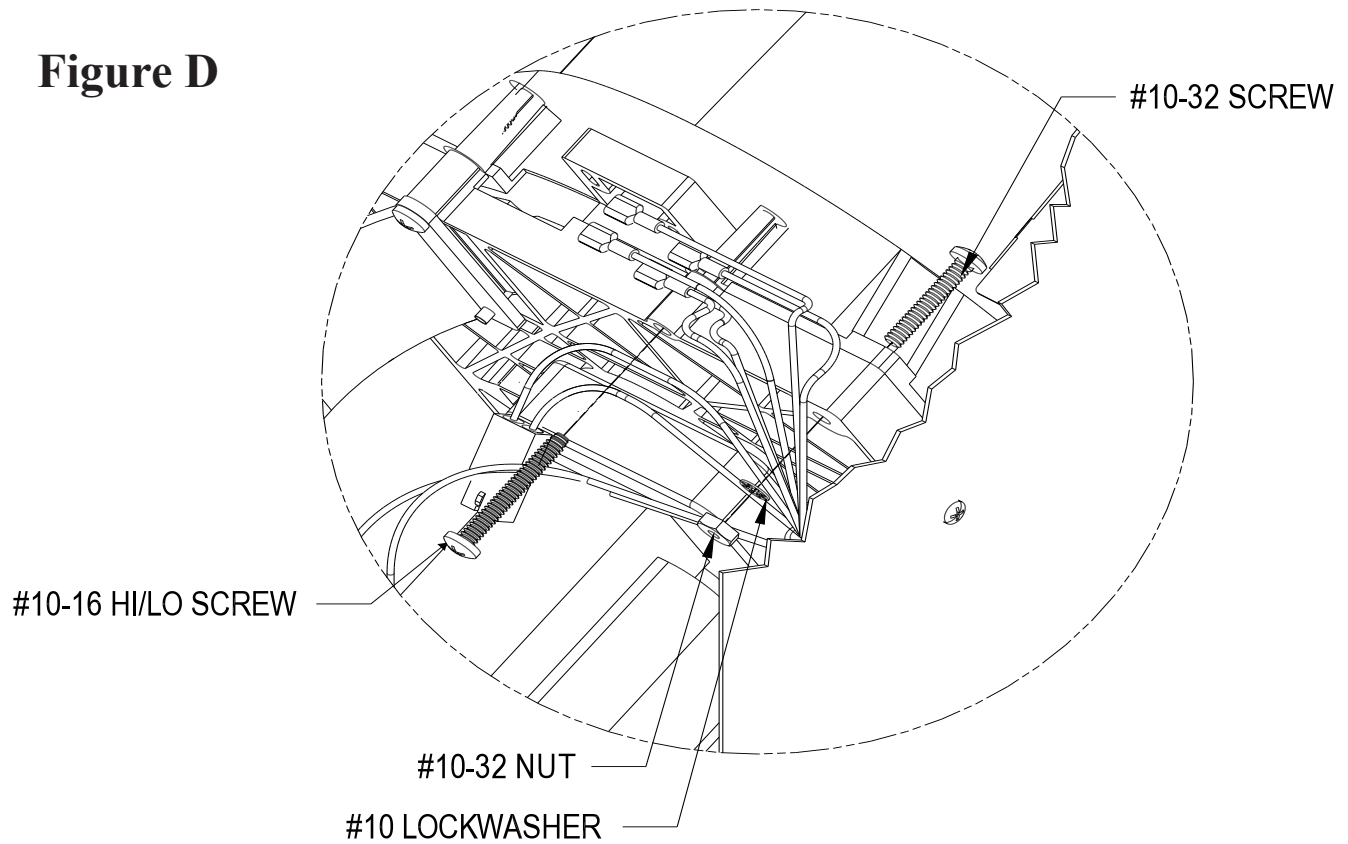
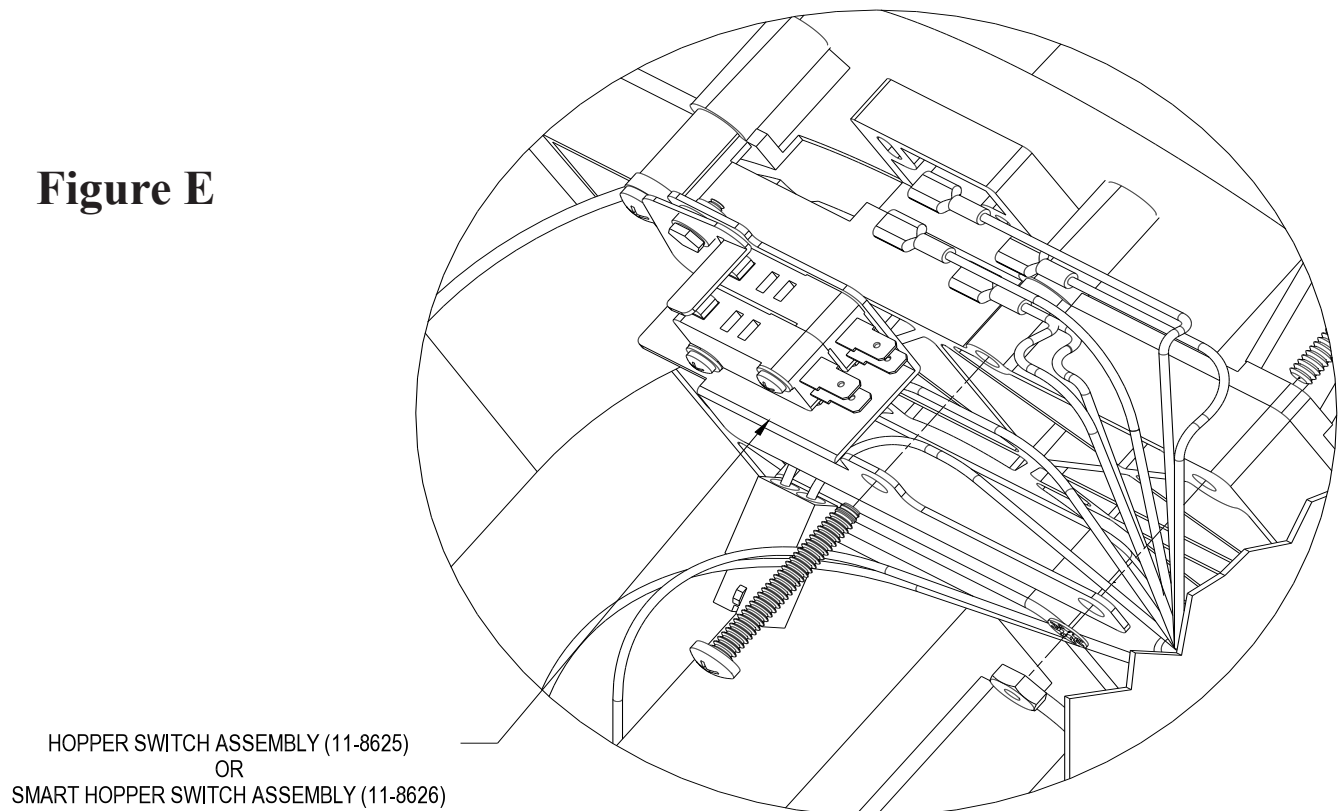
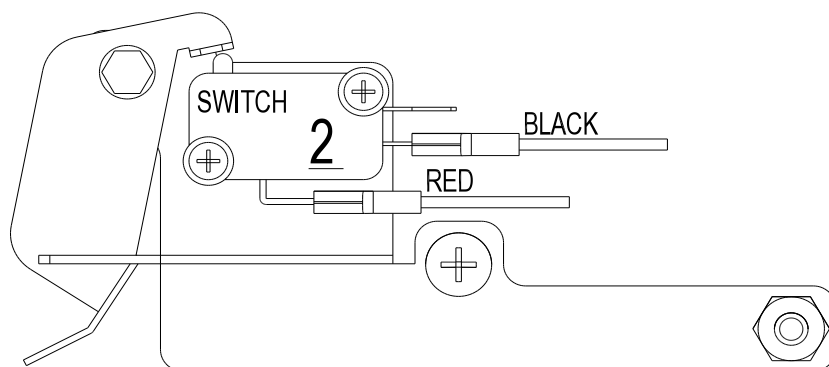
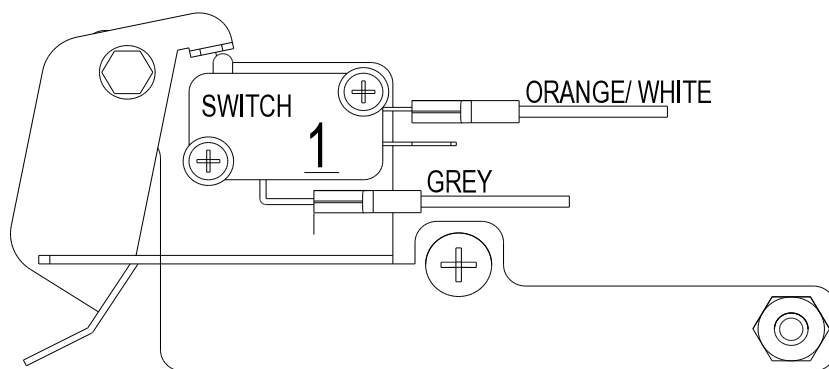
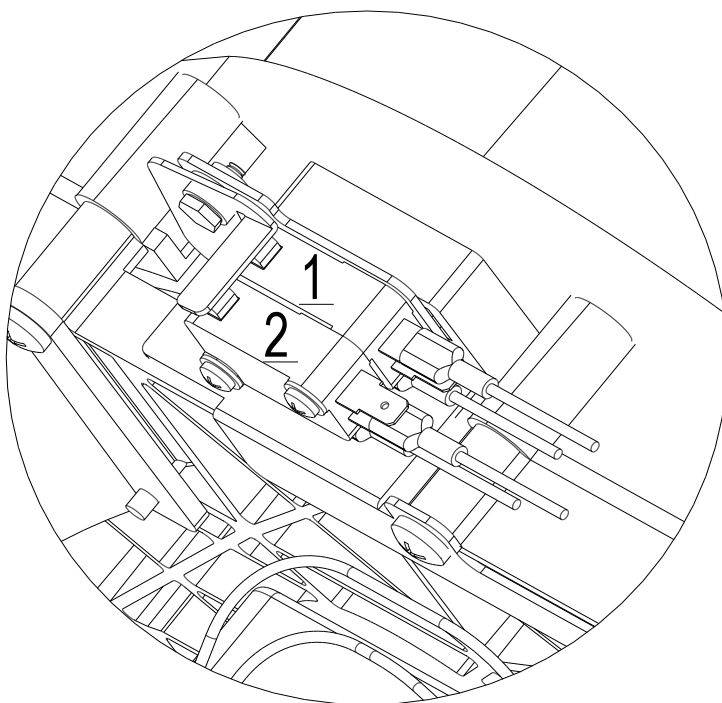

Figure E



***WARNING: CONNECTING WIRES TO SWITCH IMPROPERLY CAN
DAMAGE MACHINE***

HOPPER SWITCH ASSEMBLY (11-8625)



SMART HOPPER SWITCH ASSEMBLY (11-8626)

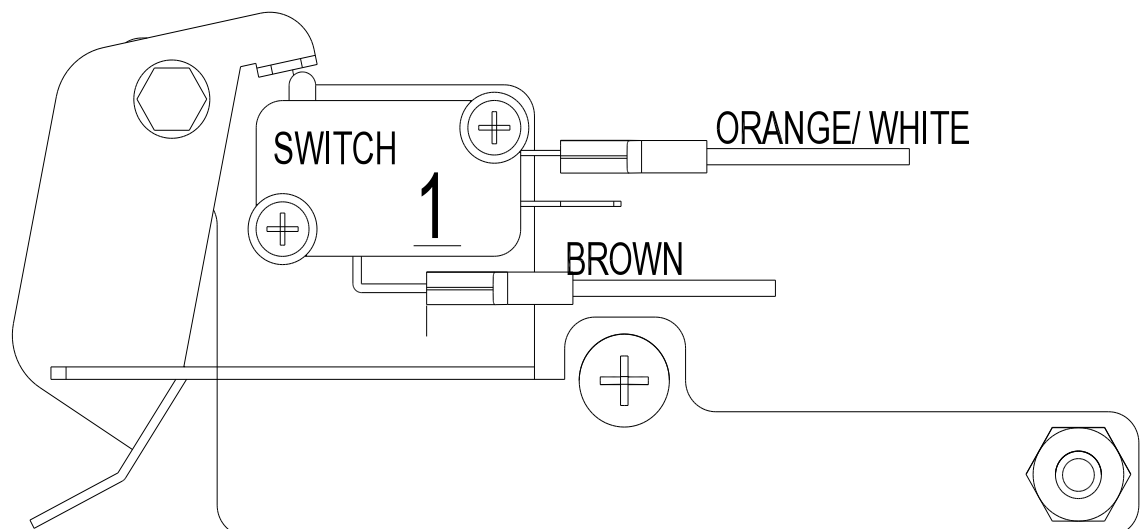
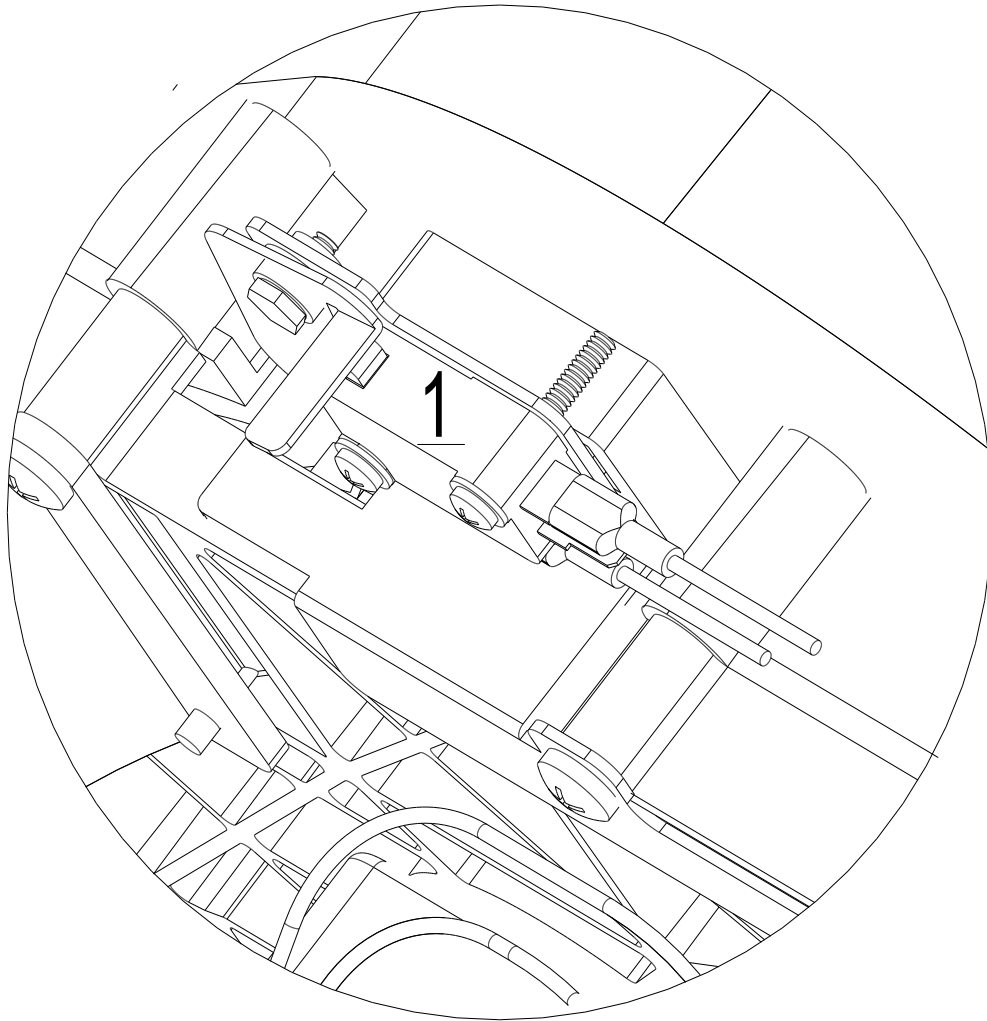

9. Re-attach quick connect to switch. Note: Refer to page 4 or 5 for the appropriate quick connect connection.
10. Replace coin baffle. Refer to Figure B
11. Replace cover and fasten using #6-32 x 3/16" (90-0131) screws. Refer to Figure A
12. If applicable replace hopper pivot rod using #1/4-20 screws.
13. Place hopper in machine and re-connect harness.
14. Restore power to machine.

Hamilton Manufacturing Corp.

1026 Hamilton Drive
Holland, OH 43528

Sales Phone: (888) 723-4858 **Sales Fax:** (419) 867-4850
Customer Service Phone: (800) 837-5561 **Customer Service Fax:** (419) 867-4857
Parts Phone: (866) 835-1721 **Parts Fax:** (419) 867-4867

Website: <http://www.hamiltonmfg.com>

Email Addresses:

service@hamiltonmfg.com

sales@hamiltonmfg.com

parts@hamiltonmfg.com